

ENCAIXE CDI 10.8 mm CHAVE FIXA ABERTA

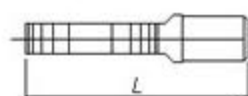

| CÓDIGO | Medidas em mm | |
|--------------|---------------|---------|
| | Abertura (mm) | L. (mm) |
| CDI - 108-10 | 10 | 51 |
| CDI - 108-11 | 11 | 51 |
| CDI - 108-12 | 12 | 51 |
| CDI - 108-13 | 13 | 51 |
| CDI - 108-14 | 14 | 51 |
| CDI - 108-15 | 15 | 51 |
| CDI - 108-16 | 16 | 56 |
| CDI - 108-17 | 17 | 56 |
| CDI - 108-18 | 18 | 56 |
| CDI - 108-19 | 19 | 65 |
| CDI - 108-20 | 20 | 65 |
| CDI - 108-21 | 21 | 69 |
| CDI - 108-22 | 22 | 69 |
| CDI - 108-24 | 24 | 74 |
| CDI - 108-26 | 26 | 78 |
| CDI - 108-27 | 27 | 78 |
| CDI - 108-28 | 28 | 84 |
| CDI - 108-30 | 30 | 85 |
| CDI - 108-32 | 32 | 90 |
| CDI - 108-36 | 36 | 104 |
| CDI - 108-38 | 38 | 104 |

CHAVE FIXA ABERTA



| CÓDIGO | Medida em Polegada | |
|----------------|--------------------|--------|
| | Abertura Pol | L.(mm) |
| CDI - 108-09.5 | 3/8" | 51 |
| CDI - 108-11.1 | 7/16" | 51 |
| CDI - 108-12.7 | 1/2" | 51 |
| CDI - 108-14.4 | 9/16" | 51 |
| CDI - 108-15.8 | 5/8" | 56 |
| CDI - 108-17.4 | 11/16" | 56 |
| CDI - 108-19.1 | 3/4" | 65 |
| CDI - 108-20.3 | 13/16" | 69 |
| CDI - 108-22.2 | 7/8" | 69 |
| CDI - 108-23.9 | 15/16" | 74 |

CHAVE FIXA FECHADA



| CÓDIGO | Medida em mm | |
|-----------------|--------------|--------|
| | Estriado mm | L.(mm) |
| CDI - 3.108-11D | 11 | 51 |
| CDI - 3.108-12D | 12 | 51 |
| CDI - 3.108-13D | 13 | 51 |
| CDI - 3.108-14D | 14 | 51 |
| CDI - 3.108-15D | 15 | 51 |
| CDI - 3.108-17D | 17 | 56 |
| CDI - 3.108-19D | 19 | 65 |

CHAVE FIXA FECHADA

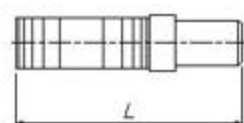
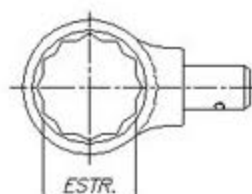

| CÓDIGO | Medida em Polegadas | |
|----------------|---------------------|--------|
| | Estriado Pol. | L.(mm) |
| CDI - 108-111D | 7/16" | 51 |
| CDI - 108-127D | 1/2" | 51 |
| CDI - 108-144D | 9/16" | 51 |
| CDI - 108-158D | 5/8" | 56 |
| CDI - 108-174D | 11/16" | 56 |
| CDI - 108-190D | 3/4" | 65 |